

PARK HILLS UNIT TWO

BEING A PORTION OF H.G. FOSTER SURVEY NO. 262,
CITY OF EL PASO, EL PASO COUNTY, TEXAS.
Containing: 10.05 ACRES

CURVE TABLE						
CURVE	RADIUS	LENGTH	TANGENT	CHORD	BEARING	DELTA
C1	1250.00	140.14	70.15	140.07	S54°52'56"W	8°25'26"
C2	1250.00	269.82	135.44	269.30	S64°16'41"W	12°22'04"
C3	1220.50	12.72	6.36	12.72	S51°58'08"W	0°35'49"
C4	1220.50	77.51	38.77	77.50	S54°05'13"W	3°38'20"
C5	1220.50	77.51	38.77	77.50	S57°43'33"W	3°38'20"
C6	1220.50	77.51	38.77	77.50	S61°21'53"W	3°38'20"
C7	1220.50	77.51	38.77	77.50	S65°00'13"W	3°38'20"
C8	1220.50	77.51	38.77	77.50	S68°38'33"W	3°38'20"
C9	30.00	41.49	38.77	24.84	N69°54'50"W	79°14'55"
C10	70.00	45.70	23.70	44.89	N48°59'33"W	37°24'22"
C11	70.00	56.86	30.10	55.31	S89°02'06"W	46°32'19"
C12	70.00	22.99	11.60	22.88	S56°21'29"W	18°48'55"
C13	30.00	12.31	6.24	12.22	N58°42'22"E	23°30'41"
C14	1279.50	50.69	25.35	50.69	S69°19'37"W	2°16'11"
C15	1279.50	72.34	36.18	72.33	S66°34'21"W	3°14'22"
C16	1279.50	85.20	42.61	85.18	S63°02'43"W	3°48'55"
C17	20.00	30.10	18.72	27.34	S75°45'06"E	86°13'18"
C18	49.00	40.98	21.78	39.80	N56°36'09"W	47°55'23"
C19	49.00	34.99	18.28	34.25	S78°58'45"W	40°54'50"
C20	49.00	35.17	18.38	34.42	S37°57'32"W	41°07'36"
C21	49.00	41.53	22.11	40.30	S06°53'16"E	48°33'59"
C22	20.00	30.10	18.72	27.34	N11°56'24"E	86°13'18"
C23	1279.50	75.49	37.75	75.48	S53°21'38"W	3°22'49"
C24	23.50	36.91	23.50	33.23	S83°19'47"E	90°00'00"
C25	24.00	22.63	12.23	21.80	S11°19'21"E	54°00'51"
C26	49.00	14.77	7.44	14.71	N03°28'13"E	17°15'56"
C27	49.00	57.33	32.46	54.12	N38°40'52"W	67°02'14"
C28	49.00	48.00	26.13	46.11	S79°44'07"W	56°07'48"
C29	49.00	48.00	26.13	46.11	S23°36'19"W	56°07'48"
C30	49.00	57.33	32.46	54.12	S37°58'41"E	67°02'14"
C31	49.00	14.77	7.44	14.71	S80°07'46"E	17°15'56"
C32	24.00	21.13	11.30	20.45	N63°32'45"W	50°25'57"
C33	23.50	36.91	23.50	33.23	N06°40'13"E	90°00'00"

LINE TABLE		
LINE	LENGTH	BEARING
L1	156.82	S33°59'44"W
L2	59.00	S59°42'38"W
L3	24.05	N30°17'22"W
L4	110.91	S59°42'38"W
L5	13.78	S27°56'54"E
L6	232.03	S68°14'32"W
L7	141.80	S59°32'43"W
L8	143.43	S52°33'16"W
L9	46.78	N31°54'21"W
L10	30.98	S20°32'45"E
L11	30.98	S20°32'45"E

SCALE: 1"=100'



LOCATION MAP

1" = 600'

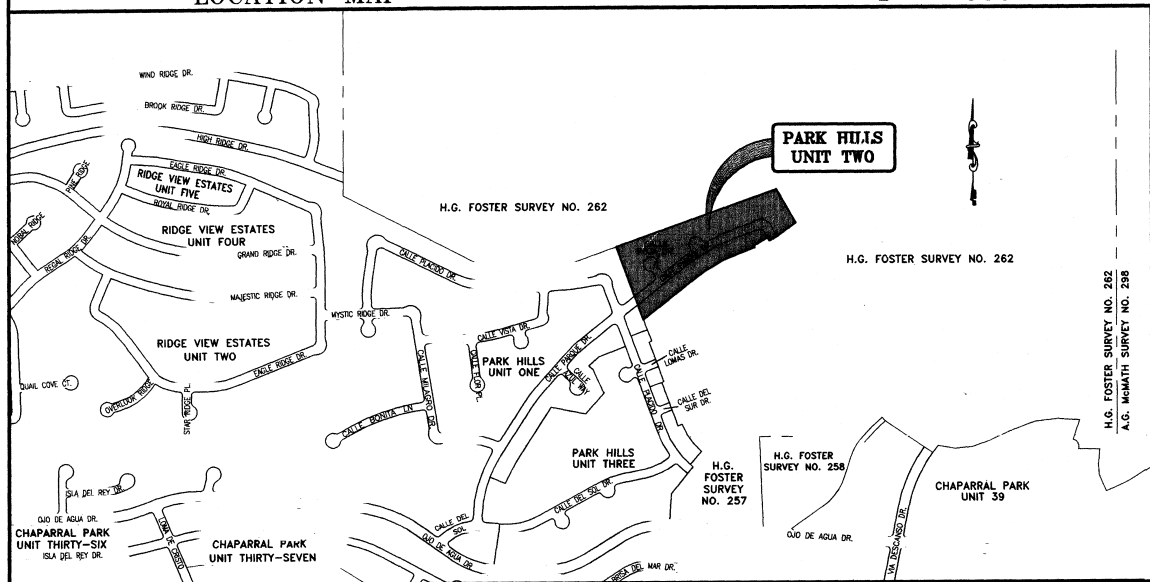

H.G. FOSTER SURVEY NO. 262
(Recorded in Book 3819, Page 1651,
Plat Records, El Paso County, Texas)

DEDICATION

E.P. PARK HILLS II, LTD., property owners of this land, hereby present this plat and dedicate to the use of the public the streets, drives, and utility easements as hereon laid down and designated, including easements for overhead of service wires for pole type utilities, and buried service wires, conduits and pipes for underground utilities, and the right to ingress and egress for service and construction and the right to trim interfering trees and shrubs.

Witness our signature this 1st day of May, 2002.

E.P. PARK HILLS II, LTD.
BY: E.P. PARK HILLS, INC.,
ITS GENERAL PARTNER

Timothy C. Foster
Timothy C. Foster, PRESIDENT

ATTEST : NOT REQUIRED

ACKNOWLEDGEMENT

STATE OF TEXAS
COUNTY OF EL PASO

Before me, the undersigned authority, on this day personally appeared Timothy C. Foster, President of E.P. PARK HILLS, INC., known to me to be the person whose name is subscribed to the foregoing instrument and acknowledged to me that he executed the same as the act and deed of said corporation for the purpose and considerations herein expressed.

Given under my hand and seal of office this 1st day of May, 2002.

Susan McMillan 3-16-05
Notary Public in and for El Paso County My Commission Expires



CITY PLAN COMMISSION

This subdivision is hereby approved as to the platting and as to the condition of the dedication in accordance with Chapter 212 of the Local Government Code of Texas this 15th day of December, 2001.

Rodolfo Valdez *Timothy C. Foster*
Secretary Chairman

Approved for filing this 28th day of MAY, 2002.

Willy Williams
Deputy Director For Building Services

FILING

Filed and recorded in the office of the County Clerk of El Paso County, Texas, this 28th day of May, 2002, A.D. in Volume 77 of the Plat Records, Page 61, File No. 2002004266

Helen Emery *Janet A. Jones*
County Clerk By Deputy

NOTES:

WATER AND SEWER SERVICES WILL BE EXTENDED TO THIS SUBDIVISION (PARK HILLS UNIT 2) FROM EXISTING EL PASO WATER UTILITIES/PUBLIC SERVICE BOARD FACILITIES AND WILL BE CONSTRUCTED AND OPERABLE AS OF MAY 30, 2002.

THE INSTRUMENT ASSURING THE CERTIFICATION THAT WATER AND SEWER SERVICES FACILITIES DESCRIBED BY THIS PLAT ARE IN COMPLIANCE WITH THE MODEL RULES ADOPTED UNDER SECTION 16.343, TEXAS WATER CODE IS FILED IN THE OFFICE OF THE COUNTY CLERK, DEED AND RECORD SECTION.
INSTRUMENT No. 2002004266 BOOK _____ PAGE _____ DATE 5-08-02

TAX CERTIFICATE FOR THIS SUBDIVISION ARE FILED IN THE OFFICE OF THE COUNTY CLERK, DEED AND RECORDS SECTION.
INSTRUMENT No. 2002004266 BOOK _____ PAGE _____ DATE 5-28-02

RESTRICTIVE COVENANTS FOR THIS SUBDIVISION ARE FILED IN THE OFFICE OF THE COUNTY CLERK, DEED AND RECORD SECTION.
INSTRUMENT No. 2002004266 BOOK _____ PAGE _____ DATE 5-28-02

LOT CORNERS WILL BE SET UPON COMPLETION OF CONSTRUCTION OF ROADWAYS AND UTILITIES.

"U.S. POSTAL SERVICE DELIVERY WILL BE PROVIDED THROUGH NEIGHBORHOOD DELIVERY AND COLLECTION BOX UNITS."

SET 1/2" REBAR WITH CAP MARKED TX 5152 AT ALL EXTERIOR BOUNDARY CORNERS UNLESS OTHERWISE NOTED.

BEARINGS BASED ON PLAT OF PARK HILLS UNIT ONE RECORDED IN VOLUME 72, PAGE 4 AND 4A, PLAT RECORDS OF EL PASO COUNTY, TEXAS

DATE OF PREPARATION: MAY 04, 2001

CONDE INC.
ENGINEERING / PLANNING
GPS / SURVEYING / CAD
1790 LEE TRIVINO DR. STE 400
EL PASO, TEXAS 79908
PH # 562-0293 FAX # 562-0286

PRKHL2F.DWG



Prepared by and under the supervision of:
YVONNE CONDE VALDEZ, P.E.
Registered Professional Engineer
Registration No. 64648

This plat represents a survey made on the ground by me or under my supervision and complies with the current Texas Board of Professional Land Survey Professional and Technical Standards.

Yvonne Conde Valdez *R. R. Conde*
Yvonne Conde Valdez, P.E. Ron R. Conde, R.P.L.S.
Registered Professional Land Surveyor
Texas License No. 5152



CITY ENGINEERING